

HUNTERS[®]

HERE TO GET *you* THERE



Southampton Way

SE5 7EJ

£1,600 Per Calendar Month



Top Floor One bed period conversion

This one bed period conversion sits on the top of an imposing Victorian Terrace and benefits from a good sized double bedroom with built in storage, spacious separate reception and a modern fitted kitchen with a range of integrated appliances.

The contemporary bathroom comes with walk in shower.

There are panoramic views of central London and the Shard from the bedroom.

Minutes from excellent transport links with easy access to the West End and City. There are a vast range of local amenities nearby including a Tesco Express a 2 minute walk away.



Area Map



Floor Plans

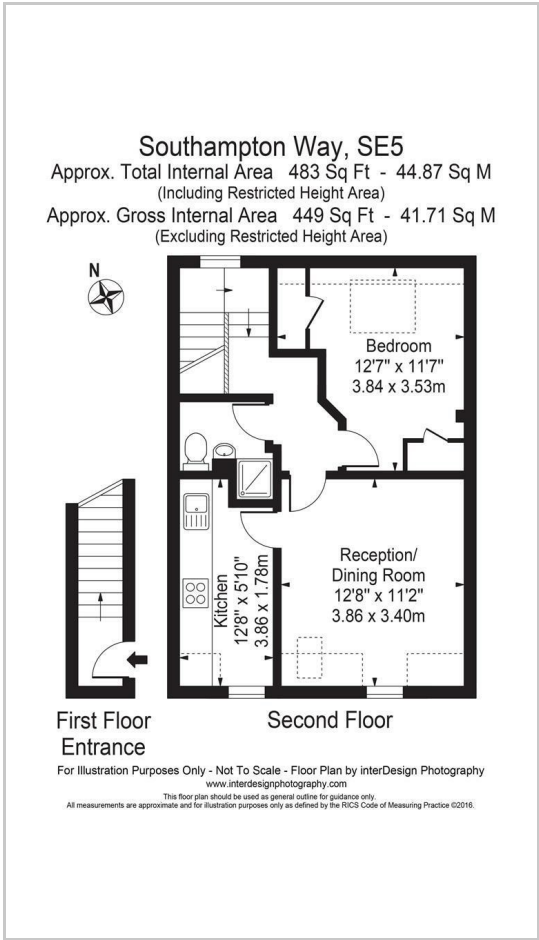

Energy Efficiency Graph

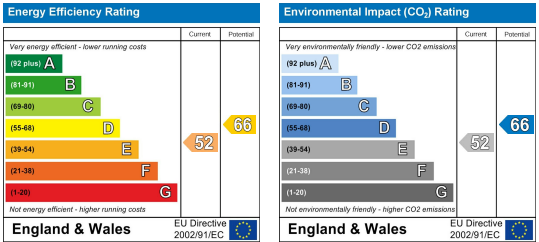

These particulars are intended to give a fair and reliable description of the property but no responsibility for any inaccuracy or error can be accepted and do not constitute an offer or contract. We have not tested any services or appliances (including central heating if fitted) referred to in these particulars and the purchasers are advised to satisfy themselves as to the working order and condition. If a property is unoccupied at any time there may be reconnection charges for any switched off/disconnected or drained services or appliances - All measurements are approximate.

THINKING OF SELLING? If you are thinking of selling your home or just curious to discover the value of your property, Hunters would be pleased to provide free, no obligation sales and marketing advice. Even if your home is outside the area covered by our local offices we can arrange a Market Appraisal through our national network of Hunters estate agents.